

The transformation of the obsolete infrastructure area of the Lerum site presents the peculiar possibility of ending up with a considerable percentage of "unused" space. The reason for this is the security distances that have to be kept from the railway and the power plant, the noise from the motorway and the unstable ground by the shore of the lake implying expensive foundations for buildings. At the same time the site is extremely attractive for an urban development because of good commuting possibilities and a beautiful natural environment.

Summing up: a site where the possibilities of the terrain vague have to be explored, a laboratory for an intensified experience that offers new chances for urbanity and urban wilderness.

1. Dérive (Drifting).

Dérive: drifting, pleasant adventure on the void.

In 1955 the artist and writer Guy Debord publishes the Guide psychogéographique de Paris which was conceived as a foldable map to be distributed to tourists. This strange guide deconstructs the city map of Paris into recognisable fragments floating in empty space. The tourist is invited to get lost following trajectories that link memories and absences.

The dérivé invited to experience the city as a playful territory where the concept of circulation means pleasure and adventure rather than functional mobility inside the circuit of the productive structures of the city.



Guide psychogéographique de Paris, Guy Debord 1955

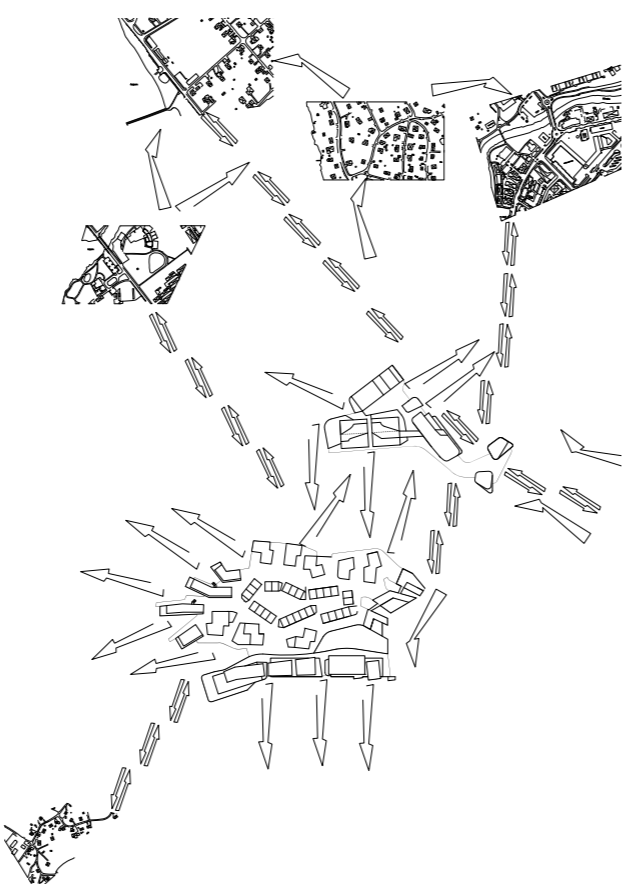

2. Voids and Space of going

Space of Going: the space made by walking

"What the roving of the artists discover (Dada, Surrealism, Lettrist, Situationist, Minimal and Land Art) is a liquid city, an amniotic fluid where the spaces of the elsewhere take spontaneous form, an urban archipelago in which to navigate by drifting. A city in which the spaces of staying are the islands in the great sea formed by the space of going."

Francesco Careri. Walkscapes. Walking as an aesthetic practice.

The void has increasingly become the protagonist of the diffuse-city landscape after having long been a backdrop presence. However, the analysis of this urban model has always started with the full parts, the solids, as if voids represented unacceptable socio-economic deterioration and abandonment running contrary to the desired image of a prosperous city.

Our proposal departs from the voids, as a journey in a system of empty spaces, urban amnesias, through which it is possible to drift; a nomadic space ramified as a system of urban sheep tracks that are at the same time the act of crossing, the architectural object and the narrative structure that investigates peripheries and make them visible.

Voids have the evocative power of absence, hope, expectancy, freedom, space of possible, the utopian, the future... Dérivé becomes the tool for integrating those metropolitan spaces that demand comprehension rather than design; and to be filled with meanings rather than with things.



A line made by walking, Richard Long 1967

